

THIS DRAWING IS UNPUBLISHED. RELEASED FOR PUBLICATION
 © COPYRIGHT BY TYCO ELECTRONICS CORPORATION. ALL RIGHTS RESERVED.

LOC	DIST	REVISIONS			
P	LTR	DESCRIPTION	DATE	DWN	APVD
GP	00	M	REVISED PER ECO-08-019103	19AUG2008	ZMRCWR

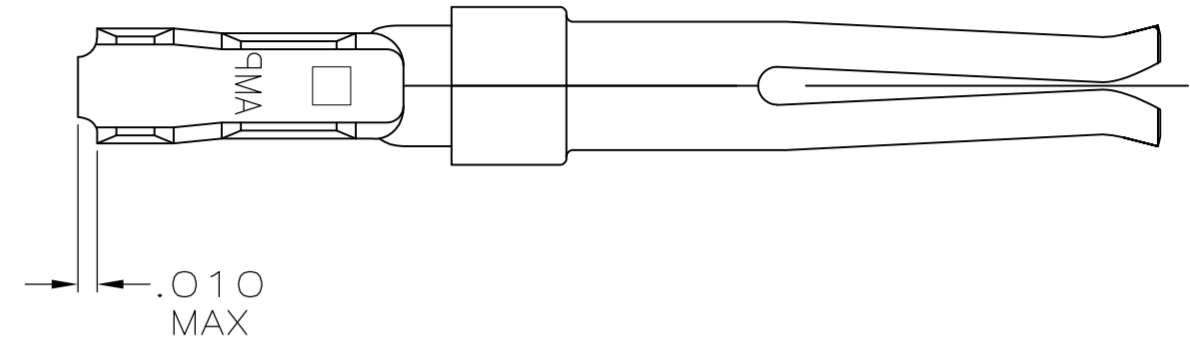

DETAIL Z

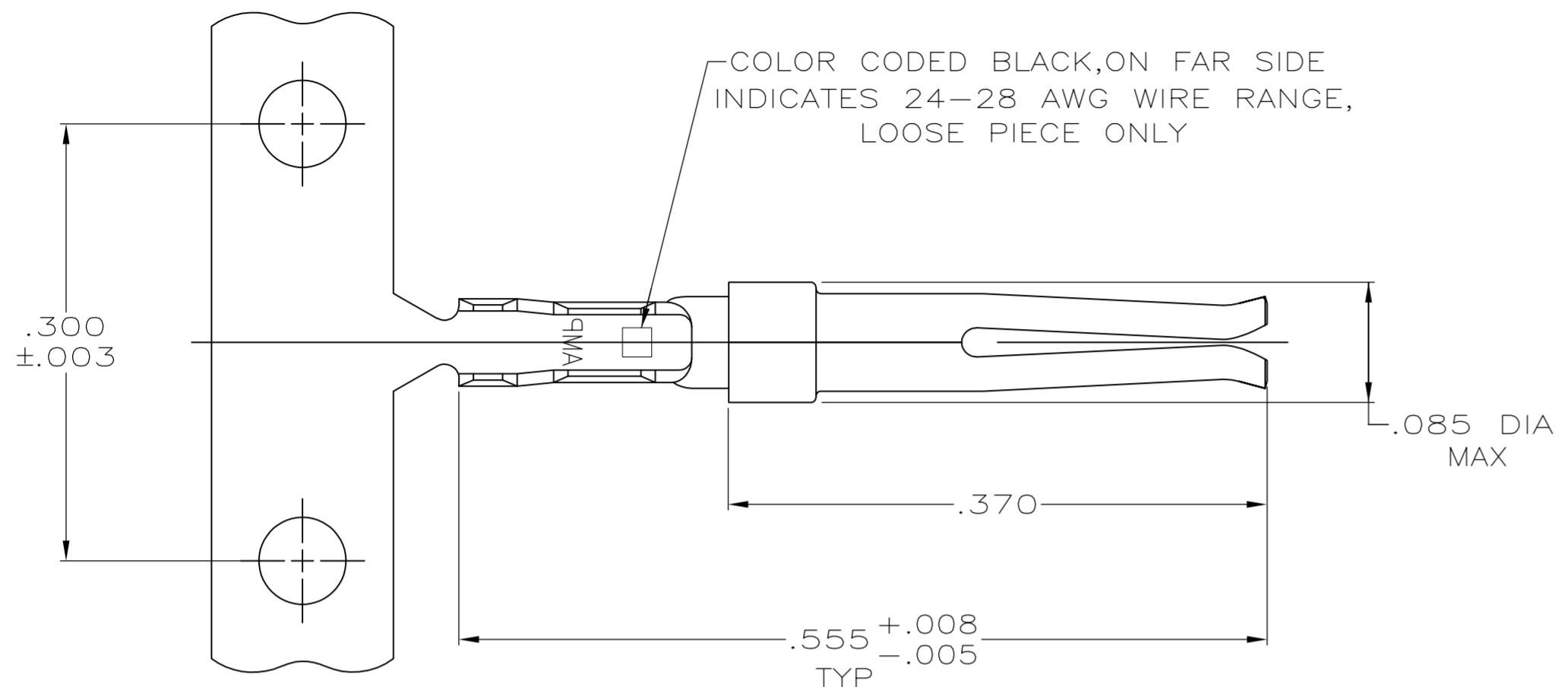
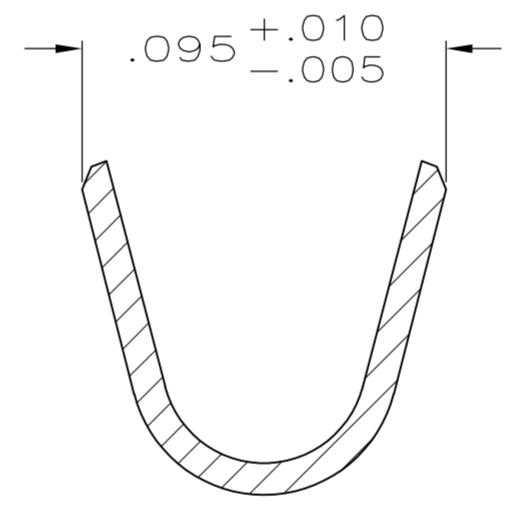
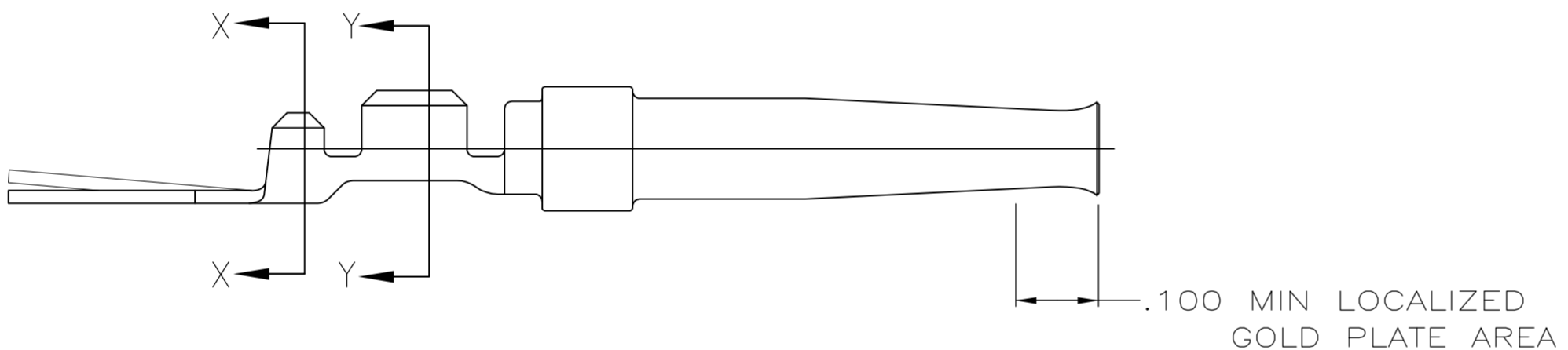

SECTION X-X
SCALE 20:1

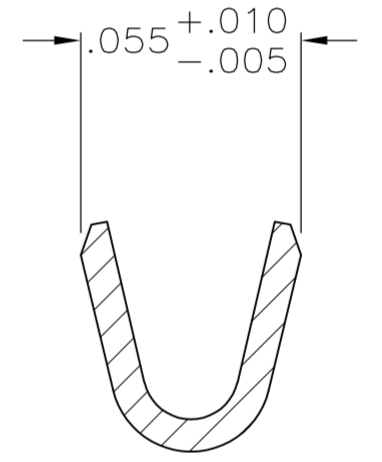

SECTION Y-Y
SCALE 20:1

- 1 GOLD PLATING PER MIL-G-45204
NICKEL PLATING PER QQ-N-290
TIN PLATING PER MIL-T-10727.
- 2 .000030 MIN GOLD IN LOCALIZED PLATE AREA, .000100 MIN TIN ON WIRE BARRELS,
ALL OVER .000050 MIN NICKEL.
- 3 GOLD FLASH IN LOCALIZED PLATE AREA, .000100 MIN TIN ON WIRE BARRELS, ALL
OVER .000030 MIN NICKEL.
- 4. CRIMP STRIP USING AMP MINI APPLICATOR.
- 5. CRIMP LOOSE PIECE USING AMP HAND TOOL ONLY.
- 6. CONTACT ACCEPTS WIRE RANGE OF 24-28 AWG AND INSULATION RANGE OF .050-.060.
- 7 PLATED WITH .000030 GOLD ON INSIDE OF LOCALIZED GOLD PLATE AREA, GOLD
FLASH ON REMAINDER, ALL OVER .000050 NICKEL UNDERPLATE.
-OR-
GOLD FLASH OVER PALLADIUM NICKEL .000030 TOTAL ON INSIDE OF LOCALIZED GOLD
PLATE AREA, GOLD FLASH ON REMAINDER, ALL OVER .000050 NICKEL UNDERPLATE.

SUPERSEDED BY 66683-4	2	SEE DETAIL Z	1-66683-2
OBSOLETE	2	-	1-66683-0
SUPERSEDED BY 66683-4	3	SEE DETAIL Z	66683-9
OBSOLETE	3	-	66683-7
	7	SEE DETAIL Z	66683-4
	7	-	66683-2
FINISH	LOOSE PIECE	PART NUMBER	

THIS DRAWING IS A CONTROLLED DOCUMENT.		DWN C. REIFSNYDER 23 JAN 96	Tyco Electronics Corporation Harrisburg, PA 17105-3608	
DIMENSIONS: INCHES		CHK R. STONE 26 MAR 96	NAME SOCKET CONTACT, SIZE 20 DF, AMPLIMITE™	
TOLERANCES UNLESS OTHERWISE SPECIFIED:		APVD P. FEINBERG 04 APR 96	DRAWING NO A2 00779 C-66683	
0 PLC ± -		PRODUCT SPEC	RESTRICTED TO	-
1 PLC ± -		APPLICATION SPEC	SCALE	10:1
2 PLC ± -		WEIGHT	SHEET	1 of 1
3 PLC ± .005		CUSTOMER DRAWING	REV	M
4 PLC ± -				
ANGLES ± -				
FINISH PHOSPHOR BRONZE PER QQ-B-750				